

Symbol



Product feature

- 1. Pilot-oriented mode: Internal pilot or external pilot.
- 2. Structure in sliding column mode: good tightness and sensitive reaction.
- 3. Three position solenoid valves have three kinds of central function for your choice.
- 4. Double control solenoid valves have memory function.
- 5. Internal hole adopts special processing technology which has little attrition friction, low start pressure and long service life.
- 6. No need to add oil for lubrication.
- 7. It is available to form integrated valve group with the base to save installation space.
- 8. Affiliated manual devices are equipped to facilitate installation and debugging.
- 9. Several standard voltage grades are optional.

Flow chart

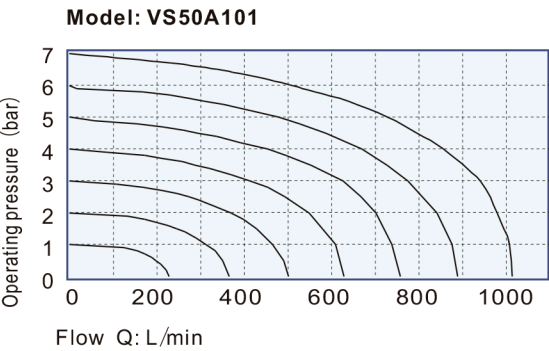

Ordering code

VS 5 0 A 1 01 - VC

① ② ③ ④ ⑤ ⑥ ⑦

| | | | |
|---|--|---|---|
| ① | Model VS: Solenoid valve | ⑥ | Port Size 01: 1/8" G |
| ② | Valve Type 5: 5/2 Way, 5/3 Way | ⑦ | Voltage DC: DC12V VC: DC24V CA: AC110V DA: AC220V VA: AC24V |
| ③ | Series Code 0: 0 Serie | | |
| ④ | Directional control A: 2 Positions B: 3 Positions | | |
| ⑤ | Acting 1: Single-acting 2: Double-acting 3: Double-acting closed center 4: Double-acting exhaust center 5: Double-acting pressure center | | |

Note: Please refer to page 140 for manifold specification and the order way.

VS50 SERIES

Specification

| | | | | | |
|--------------------|---|----------|------------------------------|----------|----------|
| Valve | VS50A101 | VS50A201 | VS50B301 | VS50B401 | VS50B501 |
| Fluid | Air(to be filtered by 40 μm filter element) | | | | |
| Acting | Internal pilot or external pilot | | | | |
| Port size | 1/8"G | | | | |
| Valve type | 5 port 2 position | | 5 port 3 position | | |
| Lubrication | Not required | | | | |
| Operating pressure | 1.5~8bar(21~114psi) | | | | |
| Proof pressure | 15bar(215psi) | | | | |
| Temperature ℃ | -20~70 | | | | |
| Orifice size | 12.0mm ² (Cv=0.67) | | 9.0mm ² (Cv=0.50) | | |
| Material of body | Aluminum alloy | | | | |

Coil specification

| Item | Specification |
|----------------------------|-------------------------------------|
| Standard voltage | AC220V, AC110V, AC24V, DC24V, DC12V |
| Scope of voltage | AC: \pm 15% DC: \pm 10% |
| Power consumption | AC:2.5VA DC:2.5W |
| Protection | IP65(DIN40050) |
| Temperature classification | B Class |
| Electrical entry | Terminal |
| Activating time | 0.05 sec and below |
| Max. frequency ① | 5 cycle/sec |

Note ①: The maximum actuation frequency is in the no-load state.

Inner structure

VS50A1

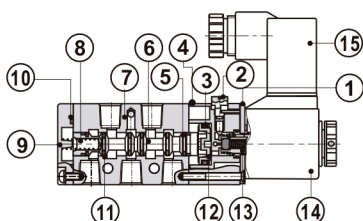

VS50A2

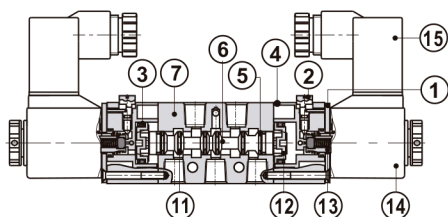

VS50B3

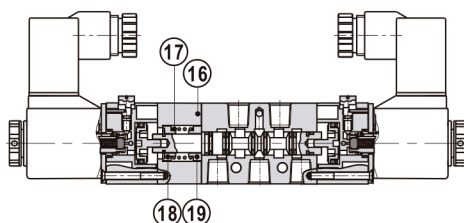

| No. | Item |
|------|---------------------|
| (1) | Fixed plate |
| (2) | Manual override |
| (3) | Piston O-ring |
| (4) | Pilot body |
| (5) | Spool packing |
| (6) | Spool |
| (7) | Body |
| (8) | Spool spring |
| (9) | Bottom cover |
| (10) | Bottom cover gasket |
| (11) | O-ring |
| (12) | Piston |
| (13) | Armature |
| (14) | Coil |
| (15) | Connector |
| (16) | Side cover |
| (17) | Return spring |
| (18) | Spring holder |
| (19) | Spring holder |

Dimensions

VS50A1

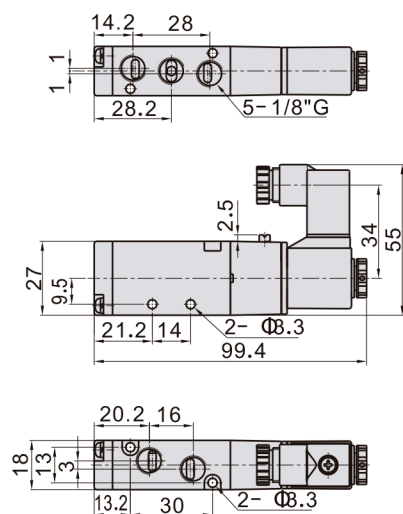

VS50A2

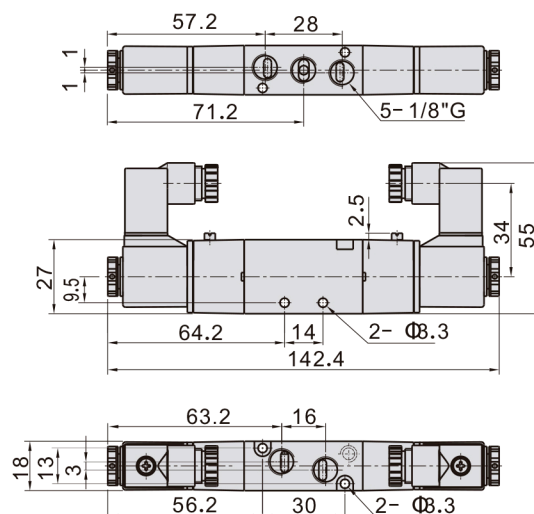

VS50B3\VS50B4\VS50B5

